

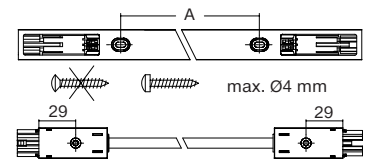

Dimensions/Wiring

Type	Ord.-No.	Measure A
SL 20.3	7 O 0xx 0x x	421 mm
SL 20.3	7 O 1xx 0x x	721 mm
SL 20.3	7 O 2xx 0x x	1.021 mm
SL 20.3	7 O 3xx 0x x	1.241 mm



Linear luminaire

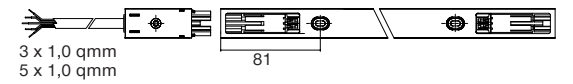

Surface-mounted linear luminaire

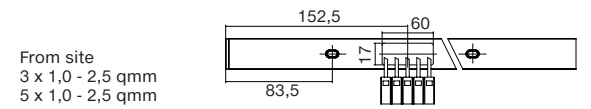

Surface-mounted linear luminaire

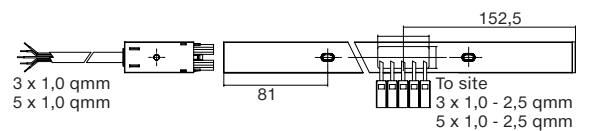

System End Module

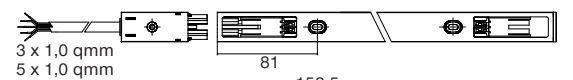

Single Surface-mounted linear luminaire

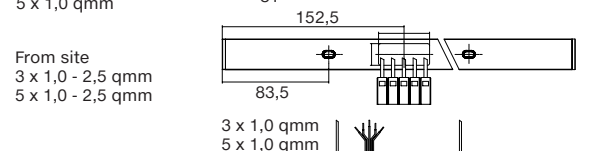

Individual Pendant luminaire

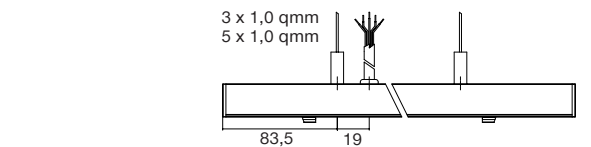

Diffusor assembly

Put diffusore in the middle of the luminaire

When cold diffusor is shorter than luminaire. It extends when warmed and closes the gap on both sides.

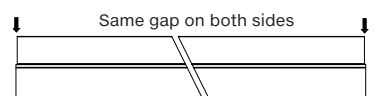

Safety instructions



The electrical connection must be performed by a professional, observing the DIN VDE regulation 0100, section 701 (power installations with nominal voltages up to 1000V)

Mains:  
Live (brown)  
Neutral (blue)  
PE (yellow/green)

Repairs must be made in compliance with DIN VDE 0701 (repair, modification and testing of electrical equipment), only!

Control DALI:  
DALI (grey)  
DALI (black)

If any luminaire is subsequently modified, the person responsible for the modification shall be considered as manufacturer.

Interface is only basic insulated

Mains connection with AL 20. For mains connection with cable without plug an installation box acc. VDE 0606 or EN 60670 should be used or similar installation space has to be provided. Use 3 or 5 connectors 5 A/230 V suitable for stranded wires 0.75 to 1.0 mm².

Installation and spacing strictly according to figure 01 ... figure 03!

Power consumption in the light line up to 1000 watts max.

Luminaire only for indoor applications

This luminaire is intended only for mounting in locations where the plug and socket are protected from unauthorized tampering or disconnection.

For emergency applications there are stickers available suitable for lamps and luminaires. They must be clearly visible when attached.

The luminaires are suitable for emergency lighting in workplaces with a particular risk.

Safety Battery Lighting Applications

Light source	Length	Colour temp.	CRI	Rated Luminous flux
3 X 20 151	583 mm	3000 K	> 80	1,500 lm
3 X 20 162	583 mm	4000 K	> 80	1,600 lm
3 X 21 221	883 mm	3000 K	> 80	2,200 lm
3 X 21 242	883 mm	4000 K	> 80	2,400 lm
3 X 22 301	1,183 mm	3000 K	> 80	3,000 lm
3 X 22 322	1,183 mm	4000 K	> 80	3,200 lm
3 X 23 361	1,403 mm	3000 K	> 80	3,600 lm
3 X 23 392	1,403 mm	4000 K	> 80	3,900 lm

Assembly

Assemble acc. Fig 01 up to ta = 40 °C

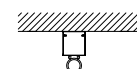

Fig. 01

Assemble acc. Fig 02 up to ta = 40 °C

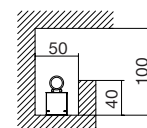

Fig. 02

Assemble acc. Fig 03 up to ta = 25 °C

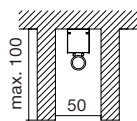
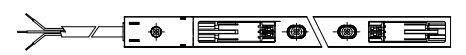
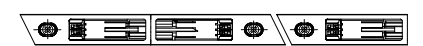

Fig. 03

Assemble the luminaire and connect AL 20 system connector



Assemble additional luminaires in the same manner.



Move the sliding plug-connector into the next luminaire. Attention! Only use a screwdriver to avoid getting injured!

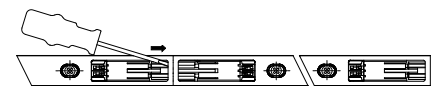

Assemble additional luminaire and connect it with a connecting cable.

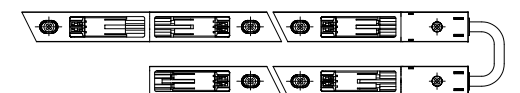

System Disassembly:  
Remove both sliding plugs with a screwdriver positioning them at the end to enable disassembly of individual luminaires from the continuous run installation.

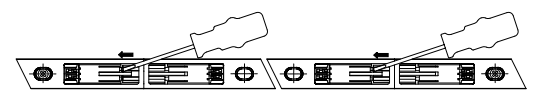

Change of lamp

Carefully remove lamp using both hands at the ends of the light source and then insert a replacement.

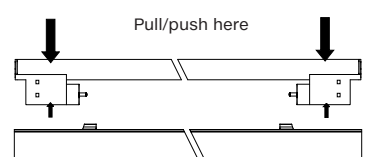

Ensure correct installation of the light source: the mark on the light source must point to the corresponding marked end of the luminaire!